

23 OTT. 2012
Progetto 1034

| | |
|-------------|---|
| descrizione | VARIANTE PIANO DI LOTTIZZAZIONE PRIVATA Frazione Coppelle del Marsi |
| richiedente | COFINI ANNA, COFINI PASQUA RANTUCCI ALBERTO |
| elaborato | RETE ACQUE NERE e BIANCHE |
| data: | Ing. Goffredo Antonini arch. Maurizio De Santoforo FEBBRAIO 2013 |

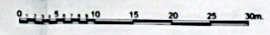

POZZETTO SU CONDOTTA ACQUE NERE
SEZIONE
Chiusura DN 24 Derby

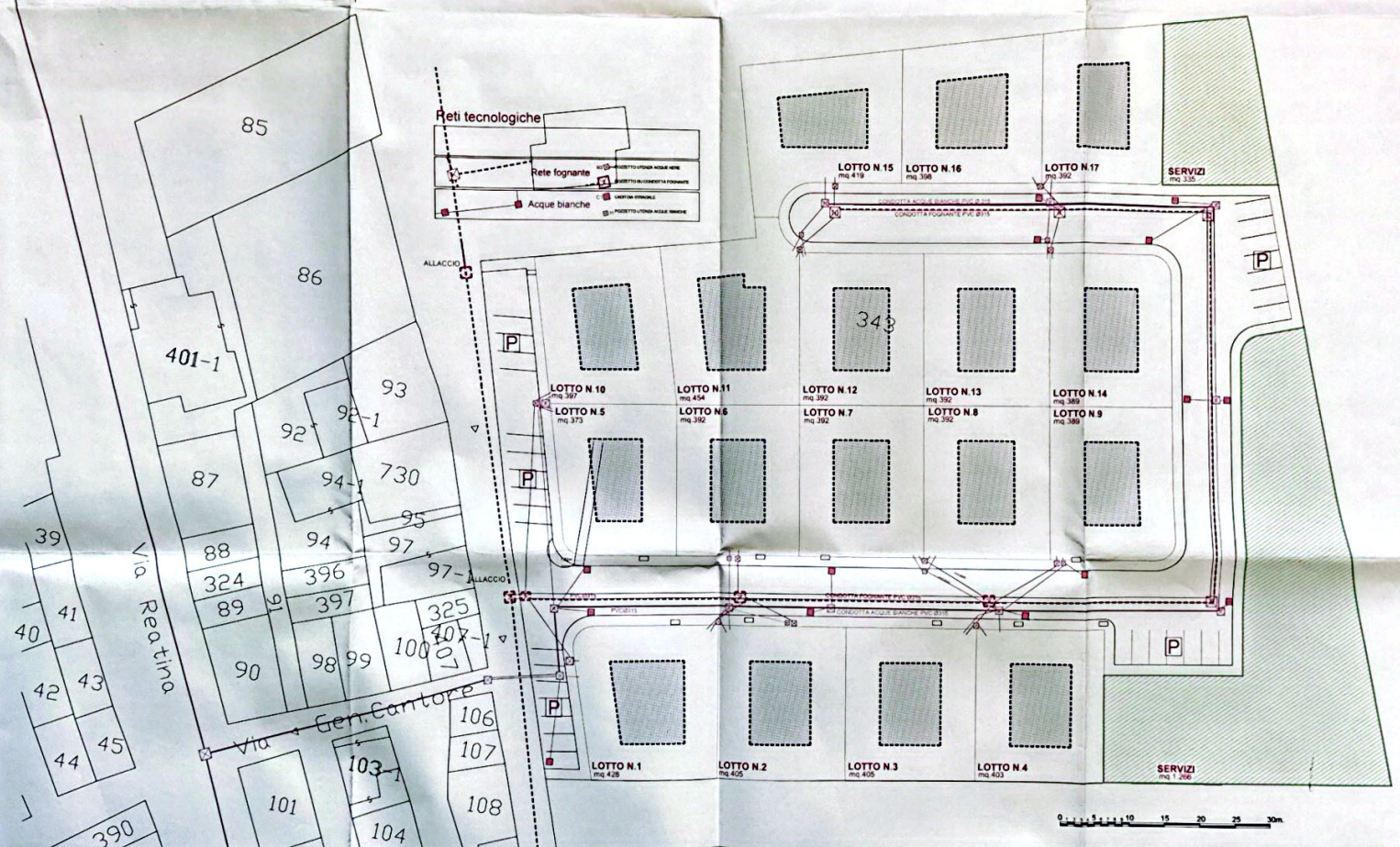
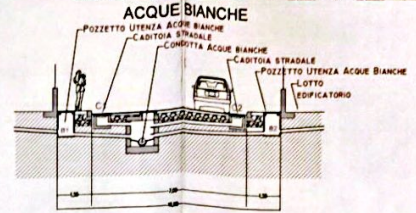
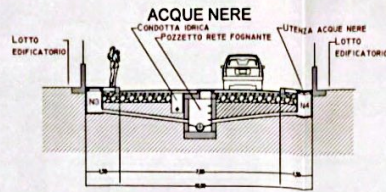
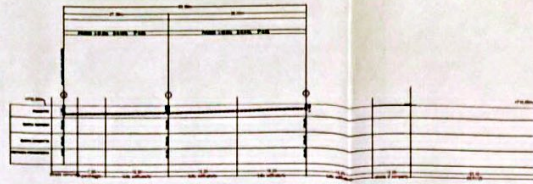
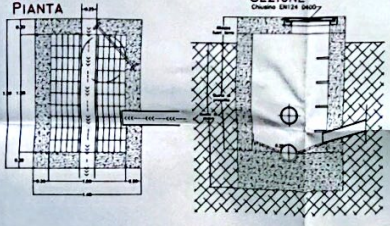

CONDOTTA IN P.V.C. Ø250

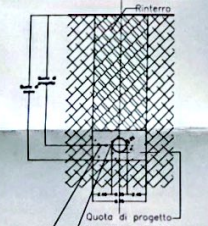

ALLACCI UTENZE ACQUE NERE

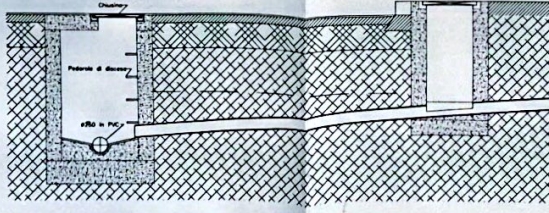

POZZETTO ACQUE BIANCHE
SEZIONE
Chiusura DN 24 Derby

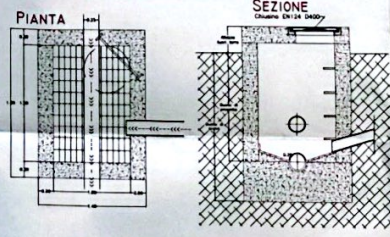

ALLACCI CADITOIE E UTENZE ACQUE BIANCHE

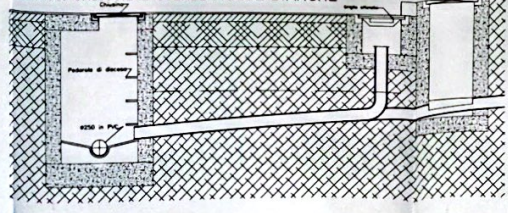

RETE IDRICA



Pozzetto su condotta di servizio

